

ALAMO AREA GIS

INAUGURAL PROFESSIONAL GIS CONFERENCE

SEPTEMBER 6 - 7, 2017

Hilton San Antonio Hill Country Hotel & Spa

SPONSORS

Special Thanks to Our Sponsors

TITLE SPONSOR



KFW has an extensive GIS database and they are running the latest in technologies to include: Civil 3D with Building Information Modeling (BIM), Low Impact Development (LID) technologies and Leica GPS and robotic Total Stations for the best speed and accuracy.

SPONSORS

Special Thanks to Our Sponsors

Platinum



Silver





Alamo Area GIS User Group

AAGIS

SAN ANTONIO, TX

The Alamo Area GIS Users Group (AAGIS) is a Professional Organization which strives to bring together GIS and Geotechnology Users and Professionals from in and around the San Antonio, TX area.

Our three main goals:

1. Sharing GIS related presentations, workflows, and ideas amongst and between group members.
2. Establishing a Professional and Social GIS Network in and around the San Antonio area.
3. Educating the Public on what GIS is and how it can help the Public and Society in general.

CURRENT 2017 OFFICERS:

President - Santiago Jaramillo
(VIA Metropolitan Transit)
president@aagis.org

Vice President - Matt Kitchen, GISP
(Adams Environmental, Inc.)
vicepresident@aagis.org

Treasurer - Robert McGarraugh IV
(City of San Antonio)
treasurer@aagis.org

Secretary - Sara Eaves
(San Antonio Housing Authority)
secretary@aagis.org

Past President - Abigail Bush, EIT, GISP, CFM
(San Antonio River Authority)

To find out how you can become a member or participate in quarterly meetings please visit www.aagis.org

The Alamo Area GIS Users Group is a subchapter of the South Central Arc Users Group. Since 1990, the South Central Arc User Group (SCAUG) has provided resources and tools for Geographic Information Systems (GIS) users and professionals in Texas, Oklahoma, Louisiana and Mississippi. If your organization is currently using or is planning to implement GIS in the future you can benefit from becoming a member of SCAUG. Membership connects you to a community of knowledgeable professionals in a growing industry. SCAUG has over a 1000 active members and continues to grow geoliteracy.

For more information on SCAUG visit
www.scaug.org



AGENDA

Day One: Workshops and Training (Sept. 6)

Training provided in partnership with TeachMeGIS.



8:00 am -12:00 pm

Introduction to ArcGIS Pro (Spanish Oaks)

12:00 pm -1:00 pm

Lunch (provided) (Rotunda)

1:00 pm—5:00 pm

Beginner Python (Spanish Oaks)

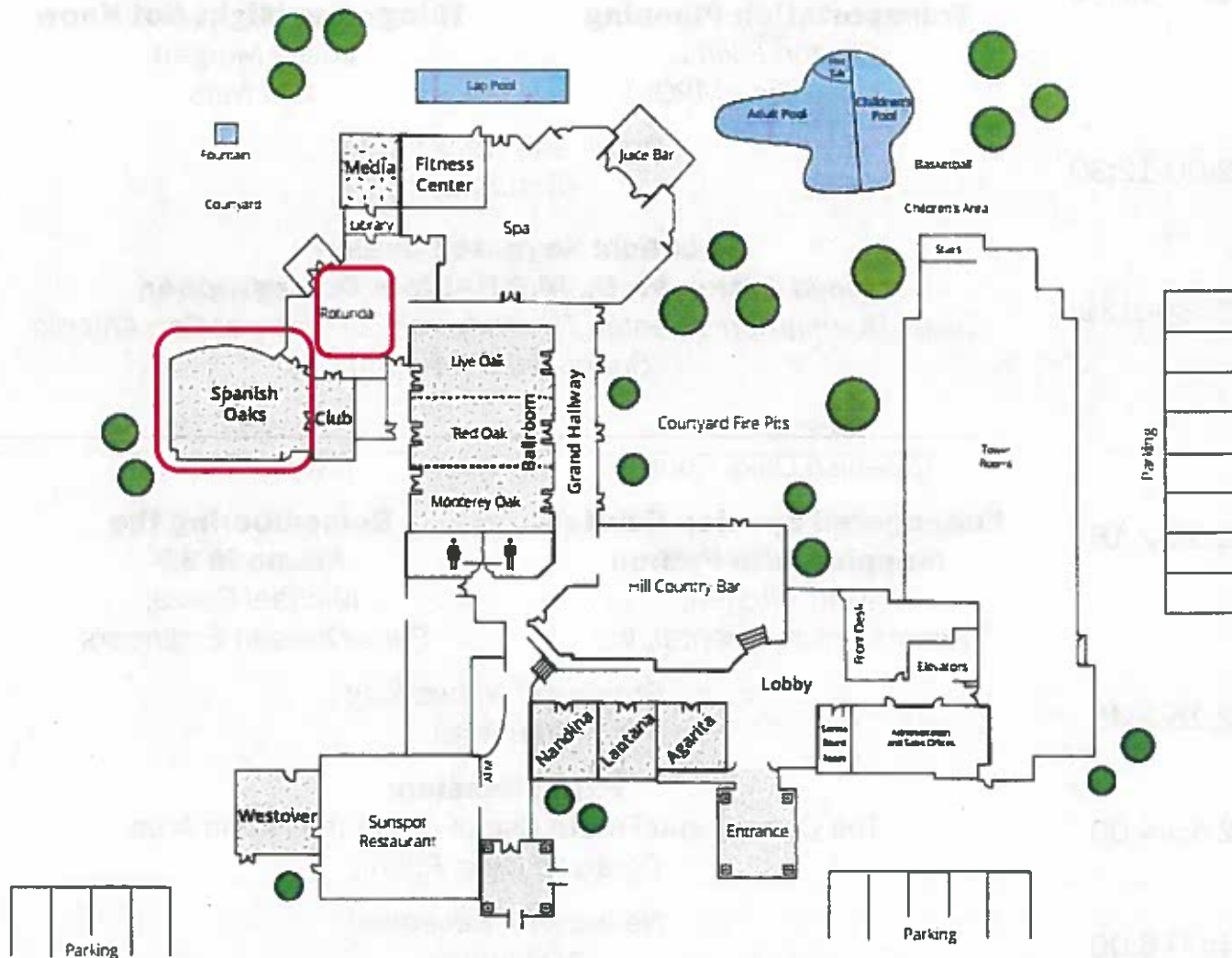

AGENDA

Day Two: Conference (Sept. 7)

9:00-10:00	Registration (Rotunda)	
	Session 1A (Spanish Oaks Room)	Session 1B (Media Room)
10:00-10:45	GIS in Local Government Eric Lomeli, Bexar County	Improving Flash Flood Response with GIS Mobile Applications Greg Brown, City of New Braunfels
10:45-11:15	Break and Networking (Rotunda)	
	Session 2A (Spanish Oaks Room)	Session 2B (Media Room)
11:15-12:00	Crash Data in Regional Transportation Planning Clayton Elkins, Alamo Area MPO	ArcGIS Web Maps: Things You Might Not Know Leslie Morgan, GIS Nuts
12:00-12:30	Break and Networking (Rotunda)	
12:30-1:30	Lunch: Keynote Speaker Lloyd Potter, Ph.D., M.P.H.—State Demographer, Texas Demographic Center, The University of Texas at San Antonio (Spanish Oaks Room)	
	Session 3A (Spanish Oaks Room)	Session 3B (Media Room)
1:30-2:15	Endangered Species Habitat Mapping with Python Matt Kitchen, Adams Environmental, Inc.	Remembering the Alamo in 3D Michael Garza, Pape-Dawson Engineers
2:15-2:45	Break and Networking (Rotunda)	
2:45-4:00	Panel Session: The Current and Future Use of GIS in the Alamo Area (Spanish Oaks Room)	
4:00-6:00	Networking Reception (AB Lounge)	

KEYNOTE

September 7, 2017

Population and Place in Texas

Lloyd Potter, Ph.D., M.P.H—State Demographer,
Texas Demographic Center,
The University of Texas at San Antonio

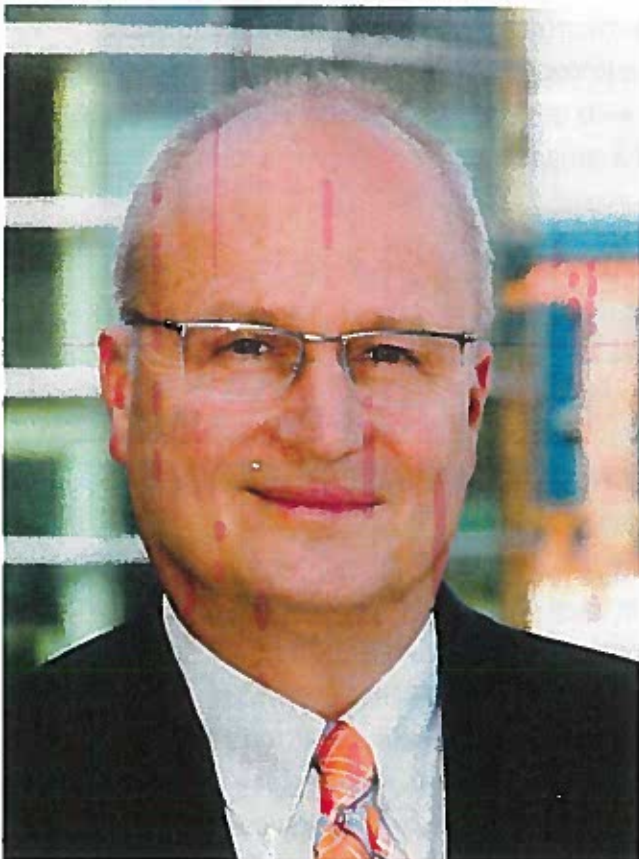

Dr. Potter was appointed as the Texas State Demographer by the Governor in May of 2010. He is also the Director of the Texas Demographic Center base within the University of Texas at San Antonio (UTSA) where he is a Professor of Demography. He holds a Ph.D. in Demography and Sociology from the University of Texas at Austin, Masters of Public Health from Emory University, Master's degree in Education from the University of Houston at Clear Lake and a Bachelor's of Science degree from Texas A&M. His current work focuses upon training applied demographers and conducting policy relevant demographic research.

SPEAKERS

Greg Brown

GIS Manager, City of New Braunfels, TX

Greg Brown, GISP, CPM is the GIS Manager at the City of New Braunfels, TX. He is a graduate of Texas State University in the field of Geography and GIS. He has been a GIS Manager for more than two decades—valuable experience that helped his team win a 2016 Esri SAG Award.



Clayton Elkins

GIS & Web Analyst, Alamo Area MPO



Clayton Elkins, a native of Houston, joined the Alamo Area MPO in June of 2008 as a GIS Analyst. Clayton graduated from Texas A&M University at Corpus Christi in May of 2007, where he attained a Bachelor of Science degree in Geographic Information Science while serving as a GIS Intern for the Corpus Christi MPO. Clayton's skillset has expanded as a member of the AAMPO team to include web development to complement his knowledge of GIS. Clayton is involved in many MPO functions, which include web development, maintaining GIS crash datasets, and facilitation at public meetings

Michael Garza

GIS Manager, Pape-Dawson Engineers

Michael Garza has been a GIS manager for over fifteen years with the past five years for Pape-Dawson Engineers in San Antonio, Texas. After graduating from Texas State University his first experience in GIS was working for a Utility conversion company where he was promoted to the title of conversion manager. He then went on to work for the City of San Antonio in the planning department and after a year was promoted to a GIS manager position for the City's Public Works Department. While there, he created one of the first GIS Right-of-Way management web based permitting systems in the nation. Michael has been selected as the subject matter expert on several multi-government committees and system integration projects. He has recently designed the GIS integration for a major water pipe line project that will cross multiple counties and involves several different stake holders and this year won the SAG award for his work in creating a story map of the Alamo and its history in 3D.



SPEAKERS

Matt Kitchen

Project Manager, Adams Environmental, Inc.



Matt Kitchen was born in Baton Rouge, Louisiana but got to San Antonio as fast as he could. He graduated from Madison High School in 2002 and from Texas State University in 2008 (Eat 'em Up!). He now resides on the northeast side of San Antonio with his lovely wife, Sable, and his dog, Bob. Matt has over 8 years of experience in GIS and environmental technical writing. He began his career as a GIS Analyst with Adams Environmental, Inc. in 2008 and has earned his place as a Project Manager. Matt received his GISP in January 2015 and completed his Master of Natural Resources from Oregon State University in March 2015. His degree in Natural Resources is supplemented with an emphasis in GIS, and upon graduation, Matt received a GIScience Certificate.

Eric Lomeli

GIS Supervisor, Bexar County

The Bexar County GIS Group was created in 2006 in order to establish a centralized GIS enterprise, serve as support to GIS users and promote GIS solutions internally and externally. Since then, their GIS footprint has grown from 3 to 30 office and departments; their database enterprise contains over 200 geographic layers; and their continually growing map gallery offers 20 web mapping applications. The Group is part of the Information Technology Department and it consists of three staff, with a combined 24 years of GIS experience and 15 years of local government service: Eric Lomeli, GIS Supervisor, Robert Hupp, GIS Analyst II, and Steve Hoff, GIS Analyst I.



Leslie H. Morgan

Independent GIS Consultant, GIS Nuts



Leslie H. Morgan, Ph.D., GISP has over 17 years of experience as a GIS professional. She is an independent GIS Consultant specializing in providing GIS analysis, support, and GIS services to clients. GIS services may include the development of GIS workflows, custom GIS tools and/or GIS web applications. Leslie's educational background is in Biological Statistics, and she is currently adjunct faculty in the graduate school at Tulane University. Leslie has a real passion for GIS, and she is honored to be serving as the South Texas State Representative for SCAUG. She is currently working on projects with Tarrant County 911, Harris County 911, and 1519 GIS. She has recently worked with SARA, the Louisiana Department of Transportation, and the Louisiana Nature Conservancy.

VENDORS

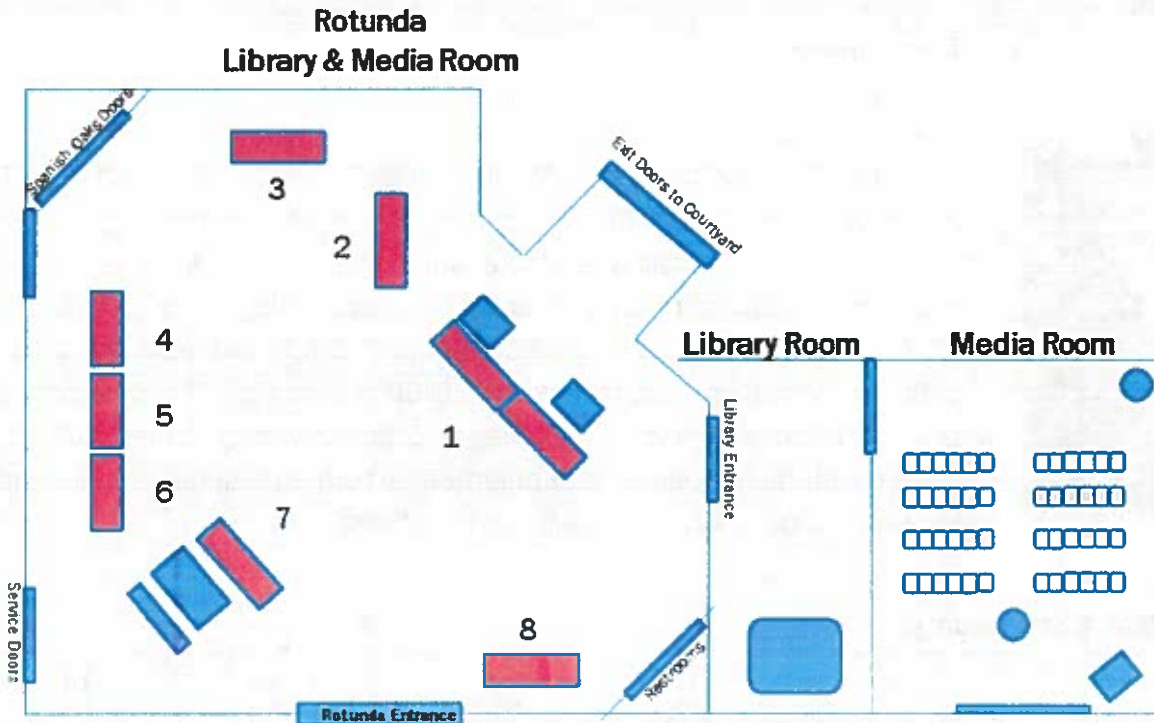

Exhibit Booth 1, KFW Engineers & Surveying

KFW has an extensive GIS database and they are running the latest in technologies to include: Civil 3D with Building Information Modeling (BIM), Low Impact Development (LID) technologies and Leica GPS and robotic Total Stations for the best speed and accuracy.



Exhibit Booth 2, Adams Environmental, Inc. (AEI)

Adams Environmental, Inc. (AEI) is a small, woman-owned business located in San Antonio, Texas. This private company has offered environmental consulting and GIS services to a diverse group of clients since 1996. AEI's environmental scientists and GIS Analysts apply GIS to their environmental projects on a daily basis. These projects include private development; non-profit conservation efforts; and municipal, state, and federal work.



Exhibit Booth 3, Pape-Dawson Engineers

Pape-Dawson has an extensive resume of successful, high profile projects in the San Antonio, Austin, Houston, Fort Worth, and Dallas areas. In the early 1980s, the City of San Antonio embarked on the \$440 million San Antonio Wastewater Facilities Improvement Program that involved upgrading sanitary sewer lines and building new



Exhibit Booth 4, TeachMeGIS

TeachMeGIS, the training branch of Inner Corridor Technologies, Inc., is a leader in Geographic Information Systems (GIS) training and consulting. Staffed with GIS professionals who have extensive industry experience, our training center offers high quality training at a reasonable price.



Exhibit Booth 5, Environmental Systems Research Institute, Inc. (Esri)

Esri® helps organizations map and model our world. Esri's GIS technology enables them to effectively analyze and manage their geographic information and make better decisions. They are supported by an experienced and knowledgeable staff and an extensive network of business partners and international distributors.



Exhibit Booth 6, Geomatic Resources

Geomatic Resources has been the Premier Authorized Leica Dealer for surveying and measurement solutions in North Texas and Oklahoma area since 2005. We are proud to have a staff that includes a Professional Land Surveyor and a Professional Engineer with a combined 100+ years of industry experience in Surveying, Construction, HDS, and Software. We provide the best products and superior solutions.



Exhibit Booth 7, United Geo Technologies, LLC

United Geo Technologies, LLC (UGT) provides geospatial solutions that encompass photogrammetry, orthophotography, parcel mapping, LiDAR and geographic information systems. UGT is a State of Texas HUB and a small, woman owned business, and certified through the South Central Texas Regional Certification Agency (SCTRCA). UGT's partners have worked together for a minimum of 20 years, fostering this unique team to focus on our clients geospatial needs and requirements.

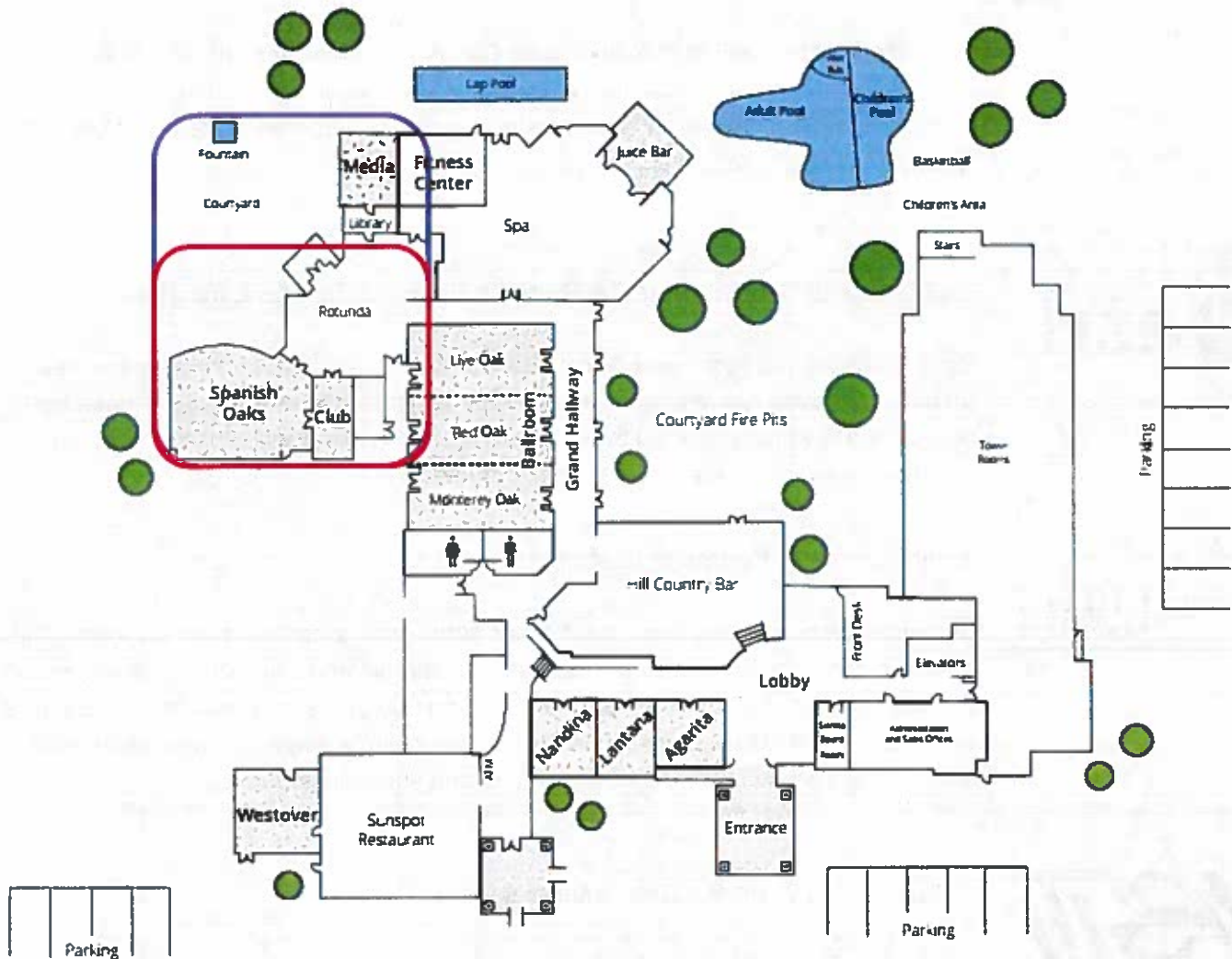

Exhibit Booth 8, Edwards Aquifer Authority (EAA)

The Edwards Aquifer Authority is a political subdivision of the State of Texas that was created to manage, enhance, and protect the Edwards Aquifer system, a major groundwater system serving approximately 2 million South Central Texans.

MAP

HOTEL LAYOUT



-  Conference Rooms
-  Training Rooms

FOR MORE INFORMATION REGARDING
Alamo Area GIS
please visit www.aagis.org